



**Direktion for use STOVE - The Stove are only designed for use with the door closed**

**Open the door:** Use the cold grip to take hold of the lug on the top part of the door. Turn by a quarter of a turn to release the door.



**Access the valve control:** Tilt the flap, the valve control and the settings will appear.



**Lighting the fire:** place a few logs in the floor of the stove. Then lay a second layer of small logs perpendicular to the bottom layer. Place a firelighter to the top.

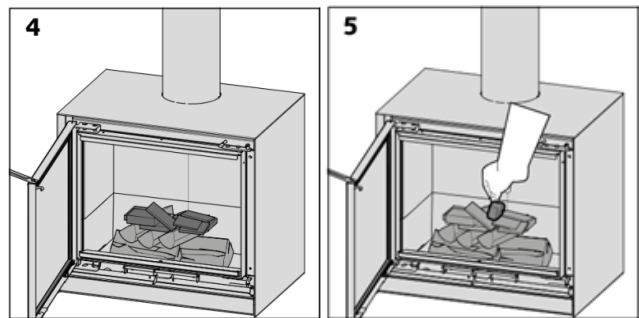

Open the air damper fully. Leave the door open slightly for 10 to 20 minutes. The start phase is complete when the combustion chamber is clean (light colour). After 45- 60 min. you can now choose another mode of operation.

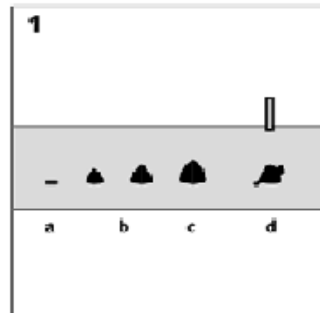

**Setting of the regulator lever:** A = valve closed / B = average rate / C = strong fire  
D: lighting - restart (only use when lighting the fire and for a few minutes when reloading)

**Putting out the fire:**  
Do not put any more fuel onto the fire.  
Reduce the air intake.  
Let the fire die down.

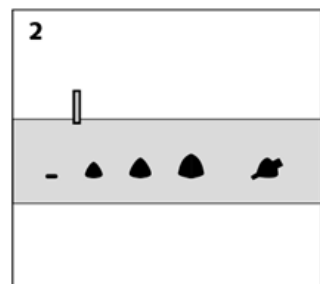

If the outside temperature is higher than inside the operation can take smoke inside the house. Use more paper and small wood to heat up the flue and to re-establish the draught.